



# BV SERIES

## 2 & 3 WAY HIGH PRESSURE BALL VALVES



32

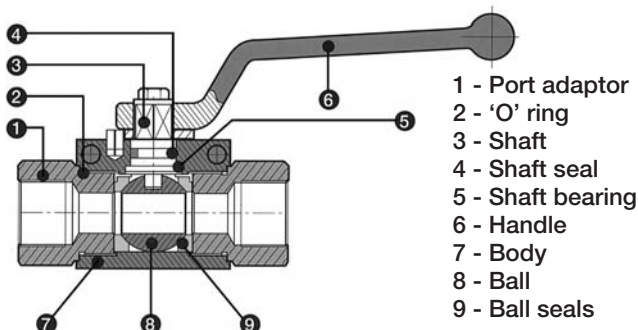

### INTRODUCTION

Holmbury BV ball valves are designed to suit a wide range of applications including mobile plant and industrial equipment. Standard valves are intended for use on hydraulic oil. Stainless steel valves are available for use in corrosive environments and/or operation with corrosive fluids, and are well suited for use in the Coal, Chemical, and Pharmaceutical industries.

These valves should not be used as flow control valves and should therefore always be fully open or fully closed.

### FEATURES

- Full bore valves provide an unrestricted flow path for negligible pressure drop.
- Floating ball on pre-compressed seals minimizes wear and provides an excellent seal at positive and negative pressures.
- Operating temperature: -20°C (-4°F) to 100°C (212°F).
- Open to close in 1/4 turn (90°).
- Offset handles are incorporated to provide good clearance for the operators hands.
- Mounting holes provided.
- Female thread ports are standard.

### MATERIALS

#### Standard Specification

- Body & port adaptor are zinc plated steel (38SMn PB 10).
- Handle - steel forging, zinc plated.
- Ball - carbon steel.
- Ball seals - DELRIN (polyacetalic resin).
- Shaft seal - nitrile.

#### Options (Special Order Only)

- Body and ball in stainless steel.
- Ball and shaft seal in PTFE.
- Optional seals and thread configurations available upon request.

### Order Codes

	<b>BVC</b>	<b>2 - 20 - N</b>	
			<b>Thread Type</b>
			G = BSP N = NPT
			S = O Ring Boss
			<b>Body Thread Size</b>
			06 = 1/4" 13 = 1/2" 25 = 1"
			10 = 3/8" 20 = 3/4"
	<b>BVC = Carbon Steel</b>		
	<b>BVS = Stainless Steel</b>		
	<b>2 = 2 Way</b>		
	<b>3 = 3 Way</b>		

Note: Not all thread types and sizes are available as stock items. Minimum order quantity may be required. Consult factory for details.



**Holmbury**

**BV SERIES,  
2 & 3 WAY  
HIGH PRESSURE  
BALL VALVES**

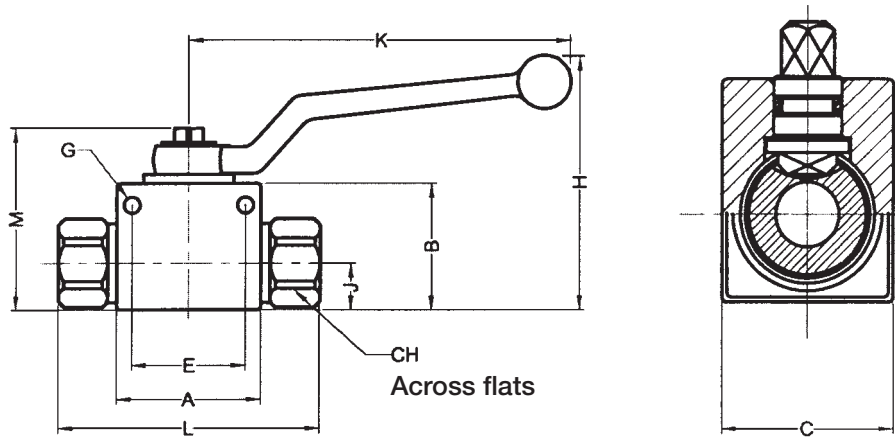

**2 Way Pressure  
Ball Valve Dimensions**

CODE	Size	Nominal Diameter	Max. Oper Pressure.	A	B	C	E	CH	G	H	J	K	L	M
				Dimensions in millimeters										
BV2-6	1/4"	6	500	40	35	26	31.5	22	4.5	71	13	105.5	72.6	45.5
			7250	1.57	1.38	1.02	1.24	0.87	0.18	2.80	0.51	4.15	2.86	1.79
BV2-10	3/8"	10	50	45	40	32	31.5	27	5.2	76	16	105.5	75.4	50.5
			7250	1.77	1.57	1.26	1.24	1.06	0.20	2.99	0.63	4.15	2.97	1.99
BV2-13	1/2"	13	500	50	45	35	38.5	30	6.5	81	17.5	105.5	84.5	55.5
			7250	1.97	1.77	1.38	1.52	1.18	0.26	3.19	0.69	4.15	3.33	2.19
BV2-20	3/4"	20	350	60	58	50	48.5	41	6.5	108	23	159.5	93.4	73
			5075	2.36	2.28	1.97	1.91	1.61	0.26	4.25	0.91	6.28	3.68	2.87
BV2-25	1"	25	350	65	65	57	50.5	46	8.5	115	27.5	159.5	114.5	80
			5075	2.56	2.56	2.24	1.99	1.81	0.33	4.53	1.08	6.28	4.51	3.15

Inches=mm/25.4 lbs=kg x 2.204622

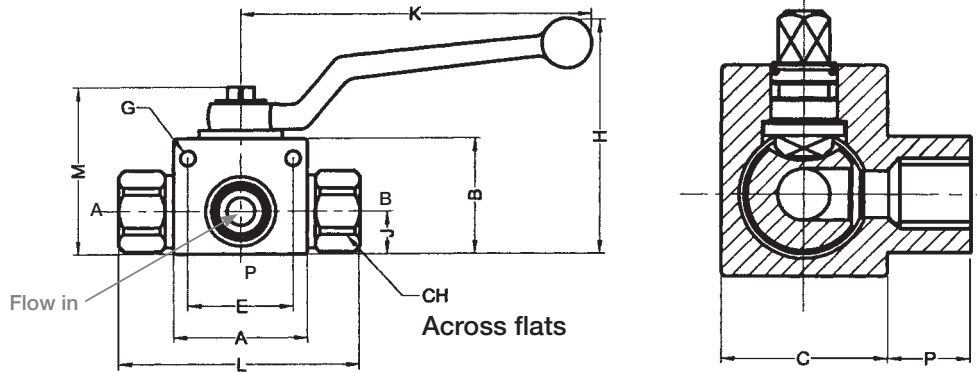
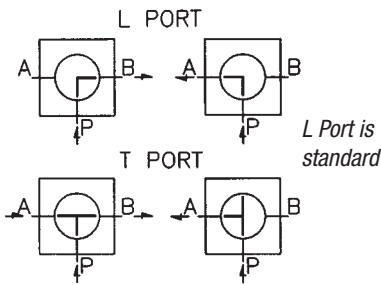

**3 Way Pressure  
Ball Valve Dimensions**

CODE	Size	Nominal Diameter	Max. Oper Pressure.	A	B	C	E	CH	G	H	J	K	L	M	P
				Dimensions in millimeters											
BV3-6	1/4"	6	500	40	35	26	31.5	22	4.5	71	13	105.5	72.6	45.5	13
			7250	1.57	1.38	1.02	1.24	0.87	0.18	2.80	0.51	4.15	2.86	1.79	0.51
BV3-10	3/8"	10	500	45	40	32	31.5	27	4.5	76	16	105.5	75.4	50.5	15
			7250	1.77	1.57	1.26	1.24	1.06	0.18	2.99	0.63	4.15	2.97	1.99	0.59
BV3-13	1/2"	13	500	50	45	35	38.5	30	6.5	81	17.5	105.5	84.5	55.5	17.5
			7250	1.97	1.77	1.38	1.52	1.18	0.26	3.19	0.69	4.15	3.33	2.19	0.69
BV3-20	3/4"	20	350	60	58	50	48.5	41	6.5	108	23	159.5	93.4	73	19
			5075	2.36	2.28	1.97	1.91	1.61	0.26	4.25	0.91	6.28	3.68	2.87	0.75
BV3-25	1"	25	350	65	65	57	50.5	46	8.5	115	27.5	159.5	114.5	80	25
			5075	2.56	2.56	2.24	1.99	1.81	0.33	4.53	1.08	6.28	4.51	3.15	0.98

Inches=mm/25.4 lbs=kg x 2.204622